

INSTRUCTION

PERDELLE-NEO

1.	IMPORTANT	2
2.	POSSIBLE ASSEMBLY	2
3.	PACKAGING - WEIGHT - DIMENSION	4
4.	NAME OF THE PARTS	5
5.	CLASSIC ASSEMBLY	7
6.	THROUGH-HOLE MOUNTING	14
7.	ADJUSTMENT	15
8.	OPERATION	15
9.	CLEANING	15

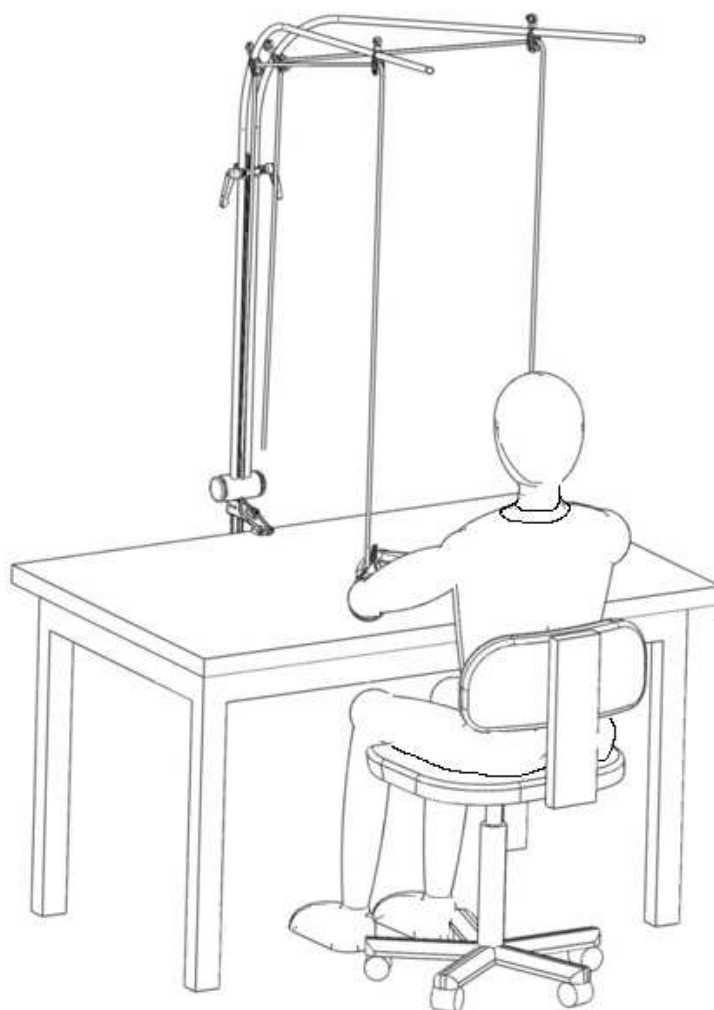

1. IMPORTANT

1. **READ THE ENTIRE MANUAL BEFORE INSTALLATION**
2. The user is responsible if Perdelle-Néo is not used for its intended purpose.
3. Do not modify the device.
4. The element on which the clamp is fixed must be stable and solid.
5. When the operator's arms are at rest in the arm bands, the underside of the arm bands must always be below the level of the work surface.
6. Change the pair of elastic bands if any are worn or damaged.
7. Check the tightness of the clamp and the 3 screws after a few hours of use, then once a week for 2 weeks, then once a month.
8. Do not force the clamp levers. Lock them with just the right amount of force!
9. There are two pairs of armbands in the box for two different operators. You can order as many armbands as there are users.

2. POSSIBLE ASSEMBLY

Perdelle-Néo is a device that improves the working conditions of repetitive movements, whether standing or sitting. This device can be installed on any solid and stable support or on the operator's chair with an adaptation. The configurations below are examples of how Perdelle-Néo can be adapted to your environment.

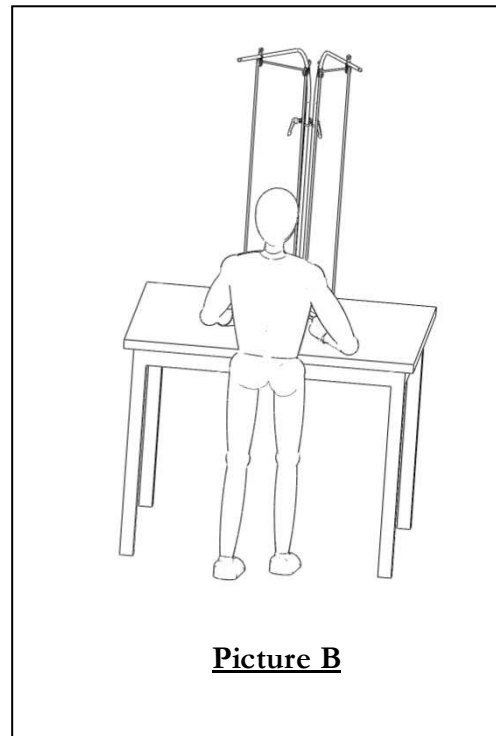
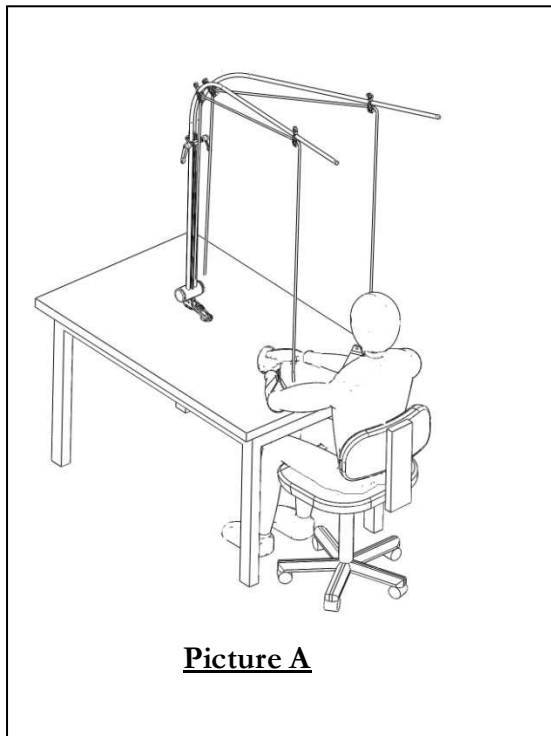

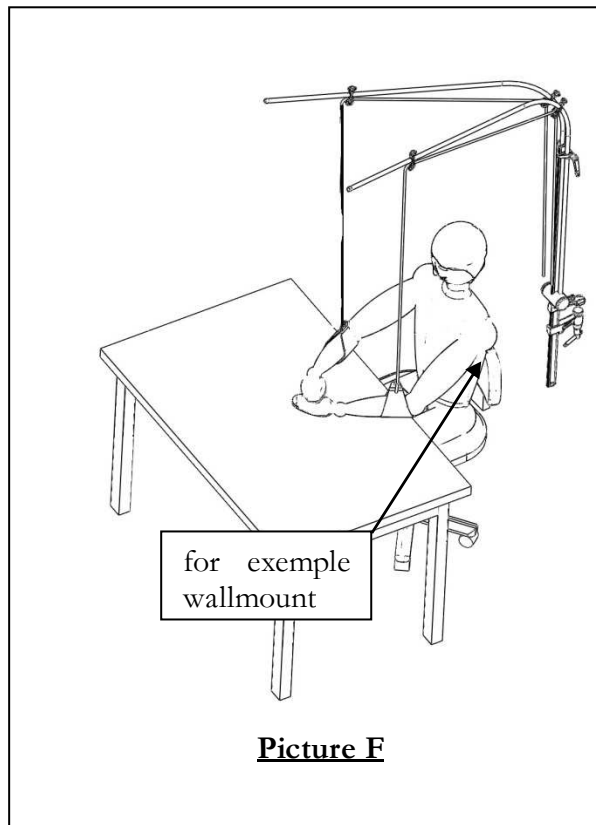
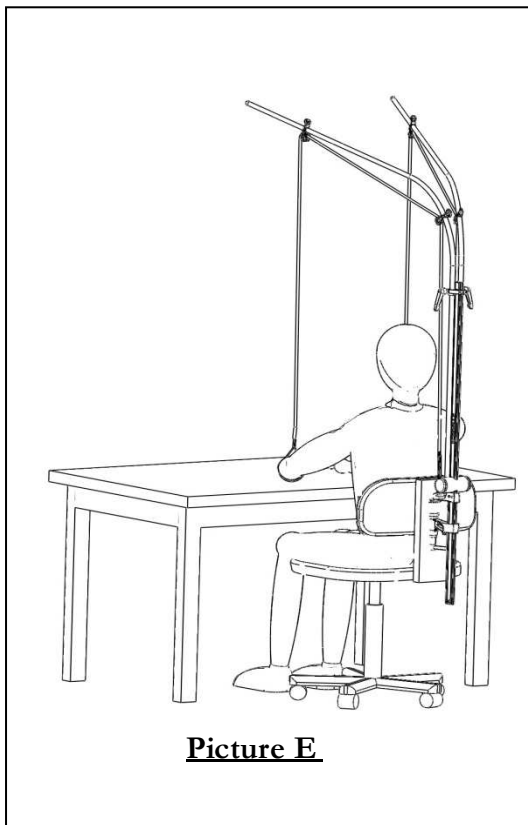
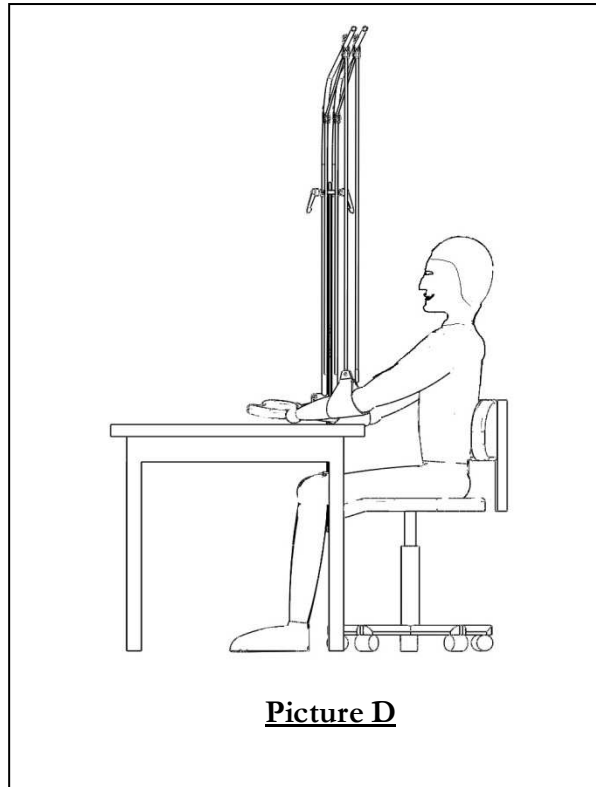
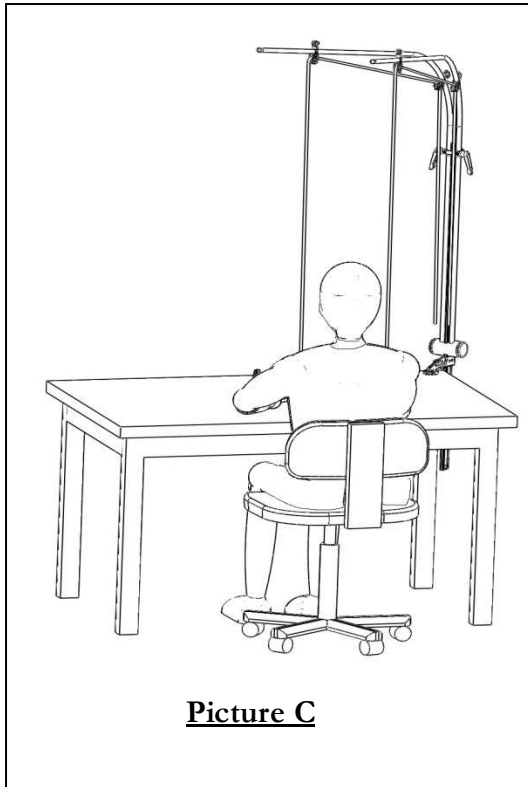

3. PACKAGING - WEIGHT - DIMENSION

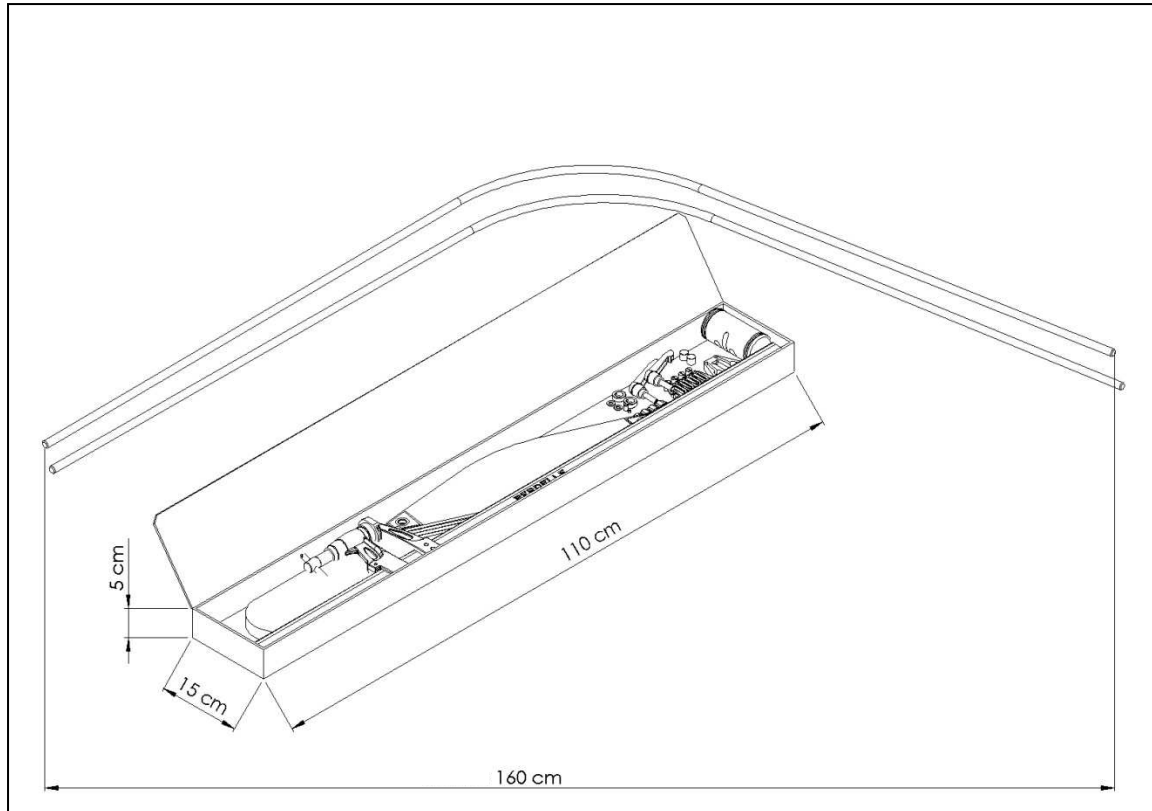

In the box :

- 1 clamp
- 1 pair of elastic bands
- 2 pairs of armbands
- 1 drum
- 1 flange
- 4 pulleys
- 4 butterfly screws
- 2 rings
- 2 handles
- 2 plugs
- 1 cap
- 2 screws M4 x 4
- 1 screw M6 x 10
- 2 washers

Near to the box are:

- 2 bows

4. NAME OF THE PARTS

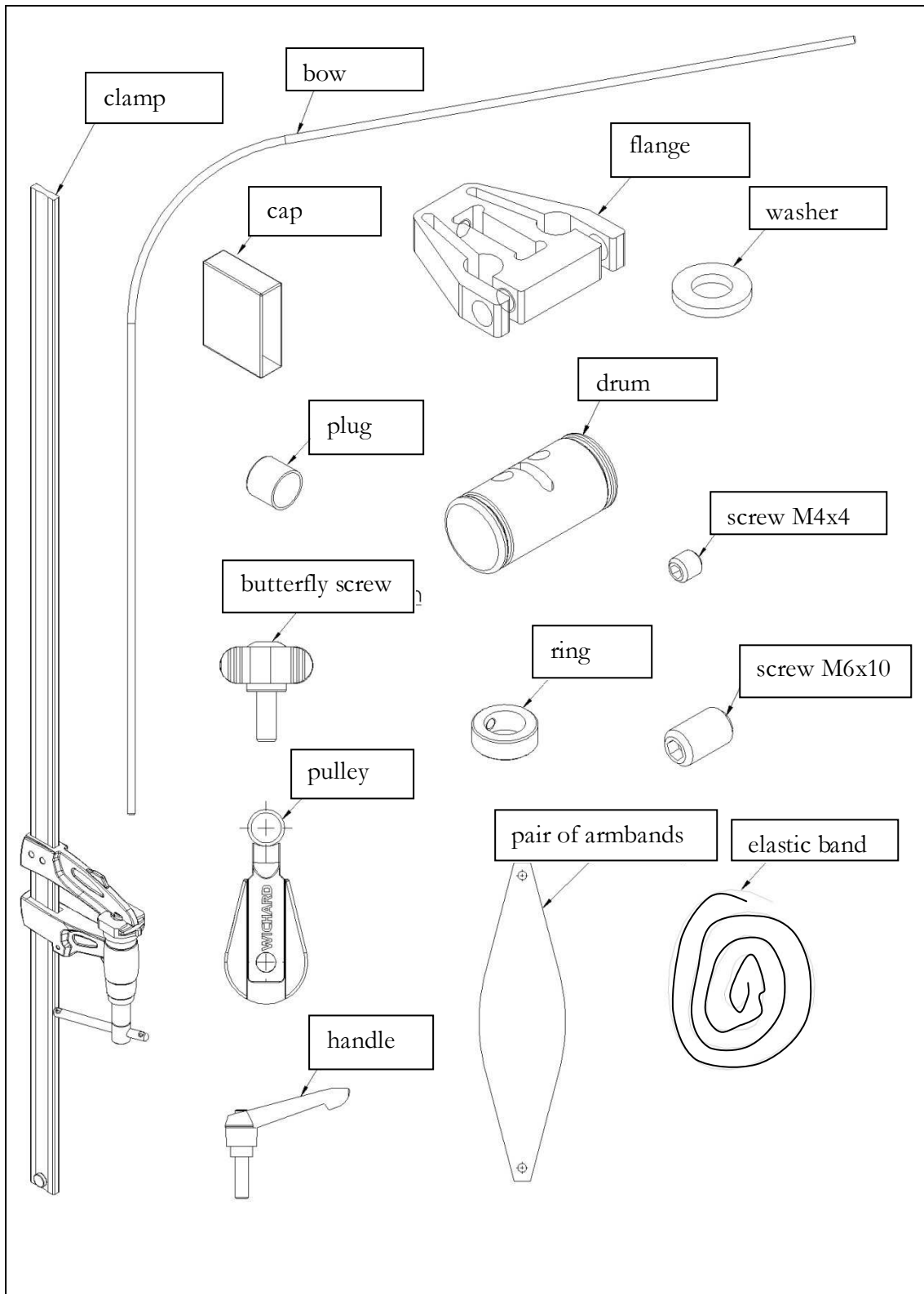

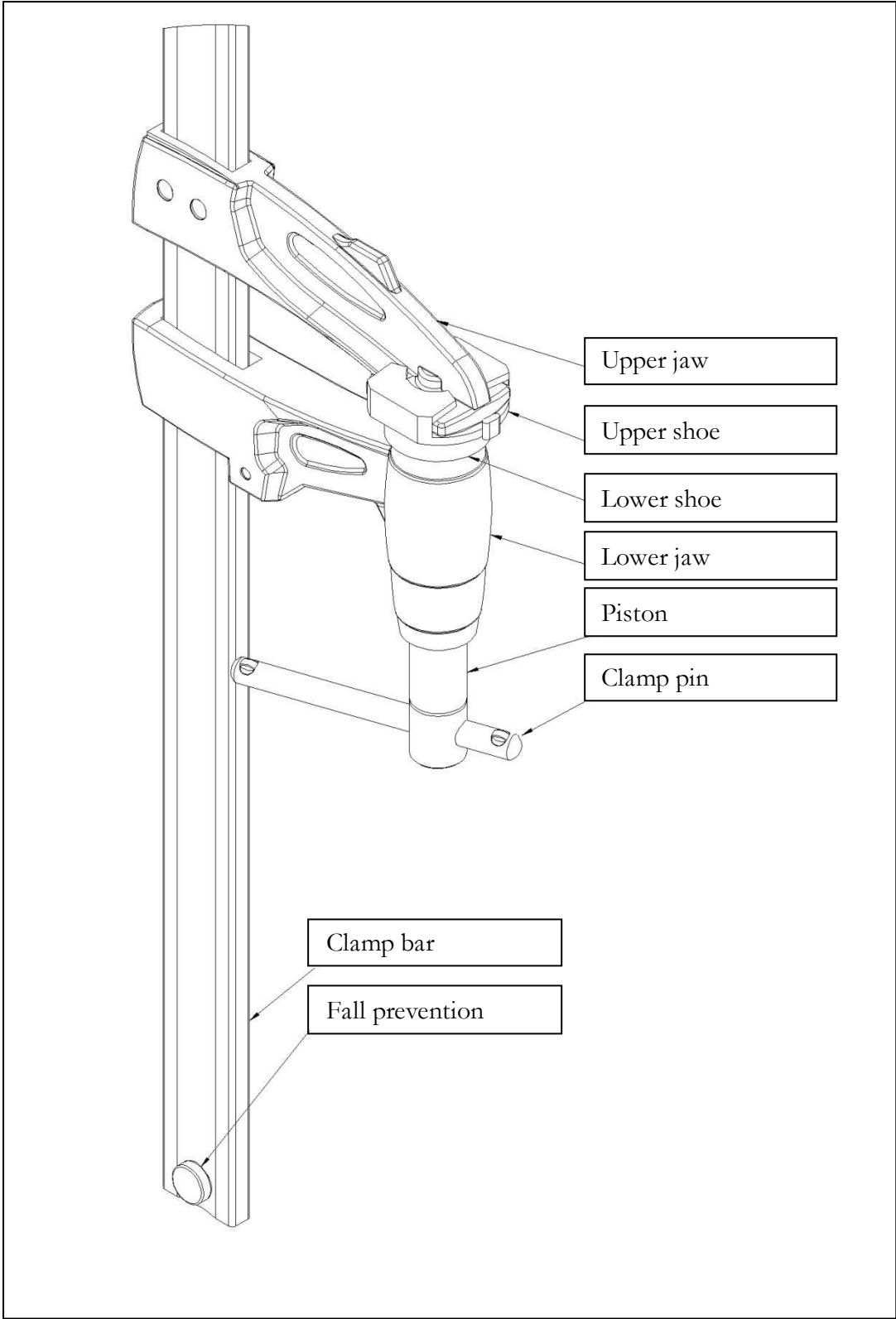

5. CLASSIC ASSEMBLY

- The assembly is carried out by a technician.
- Required tools: 2 BTR wrenches n°3 and n° 5 and a torque wrench 0.5 to 3 N.m

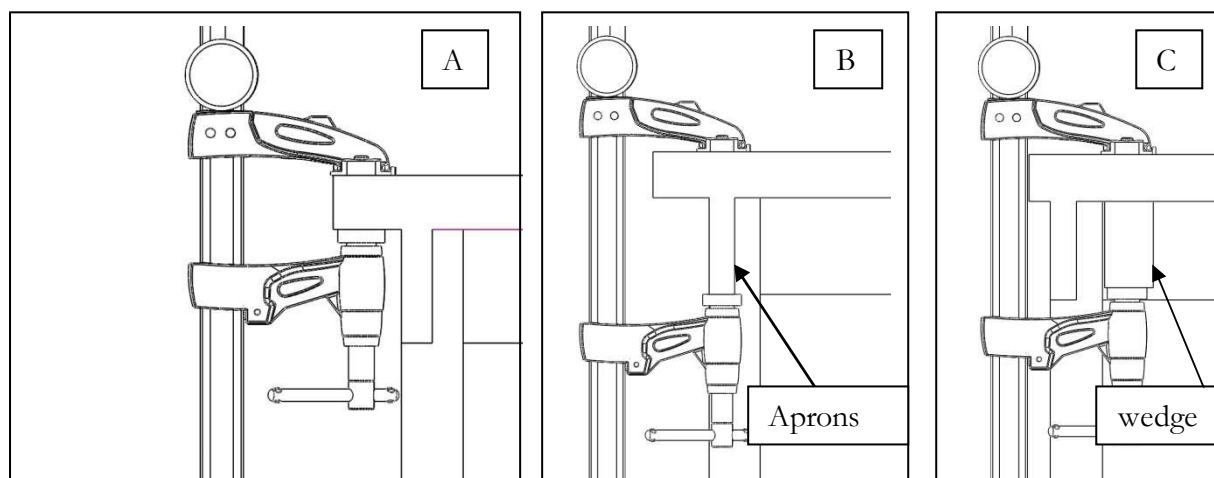
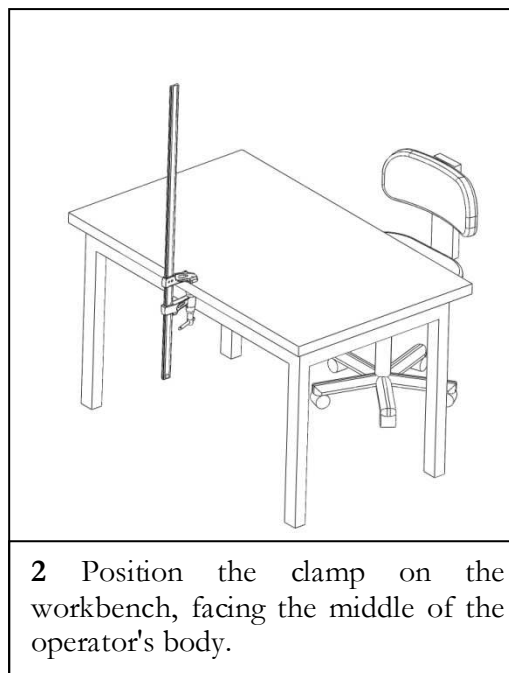
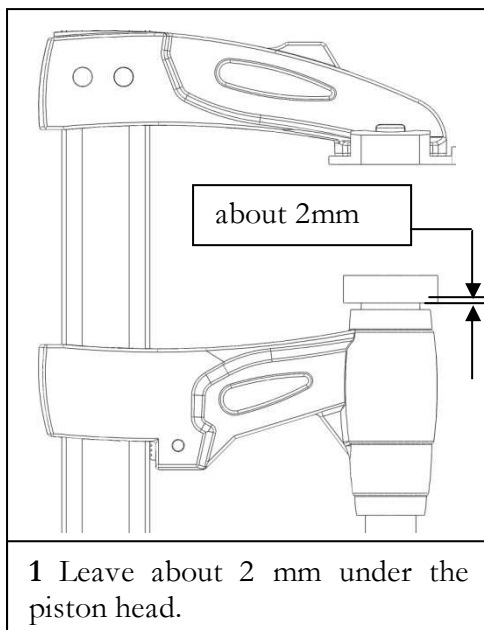

3 Approach the clamp as close as possible to the edge of the workbench in one of the configurations A, B or C.

Once the two jaws are in contact, make between 1.5 and 2 turns of tightening.

Caution: Do not use an extension tube for clamping. The area where the clamp is attached must be stable and solid.

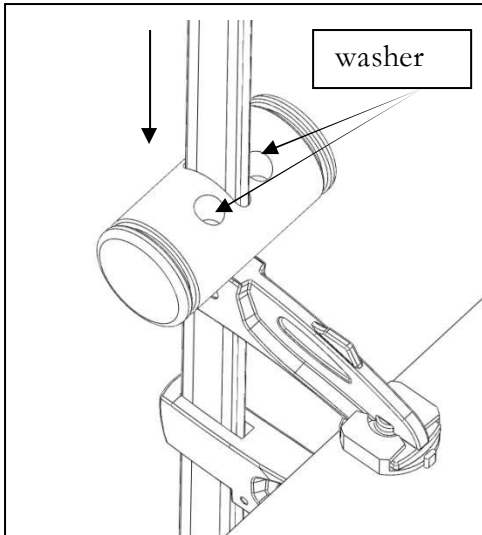

5 Slide the drum onto the clamp bar with the two holes facing the operator and place a washer in each hole.

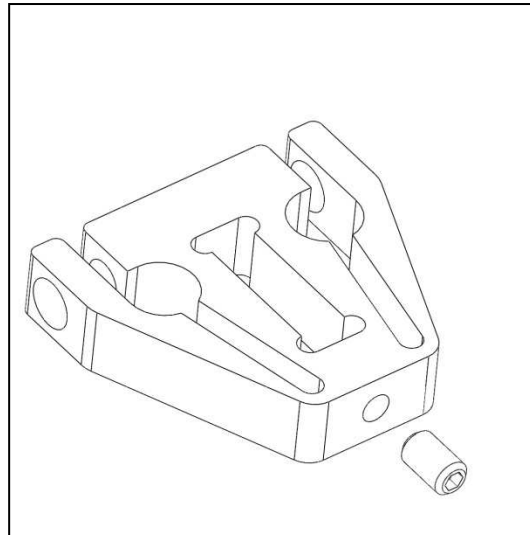

6 Screw M6 x 10 into the flange.

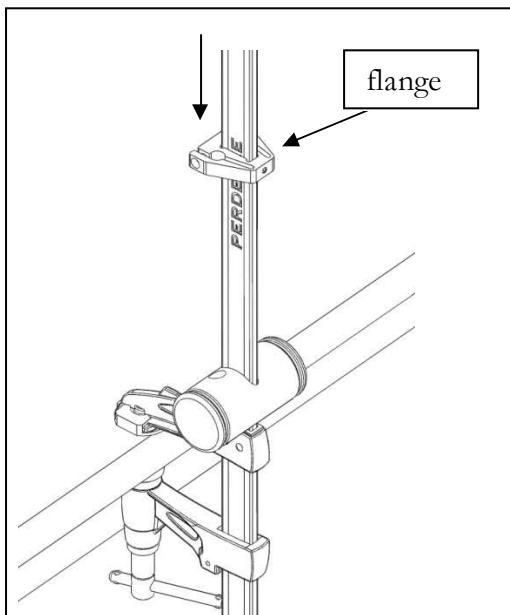

7 Slide the flange about 20 cm from the drum and slightly tighten its screw.

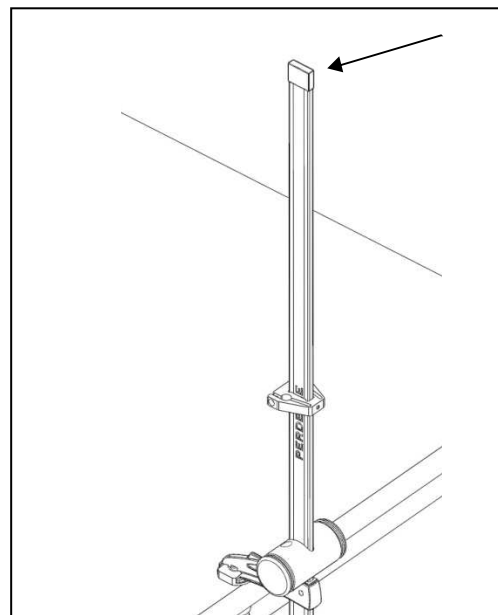

8 Put the cap on the bar of the clamp.

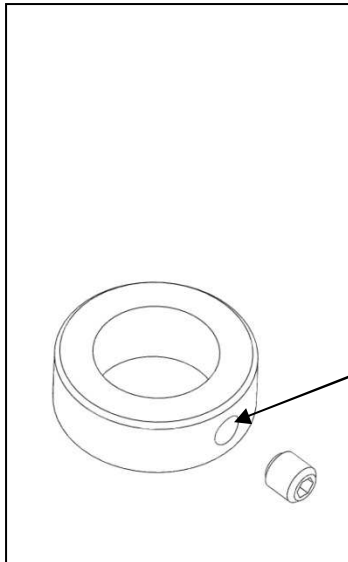

9 Insert the M4 x 4 in the ring.

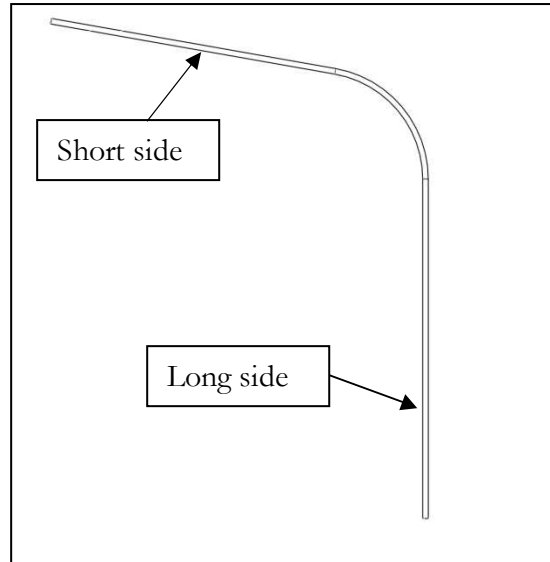

10 Choose the short or long side of the bow according to the depth of the workbench.

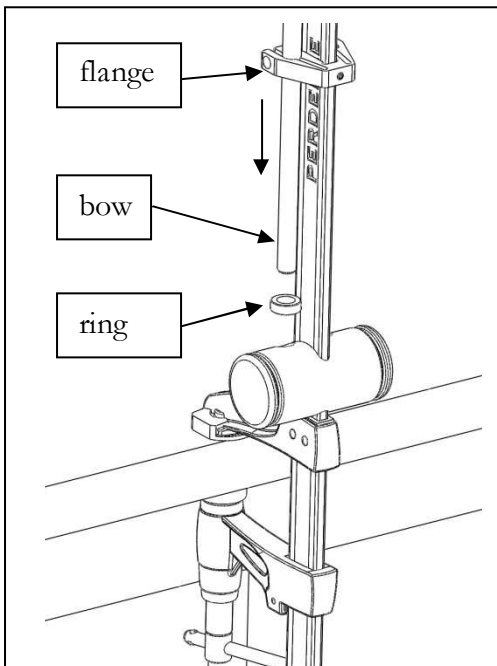

11 Pass the bow through the flange and then through the ring and...

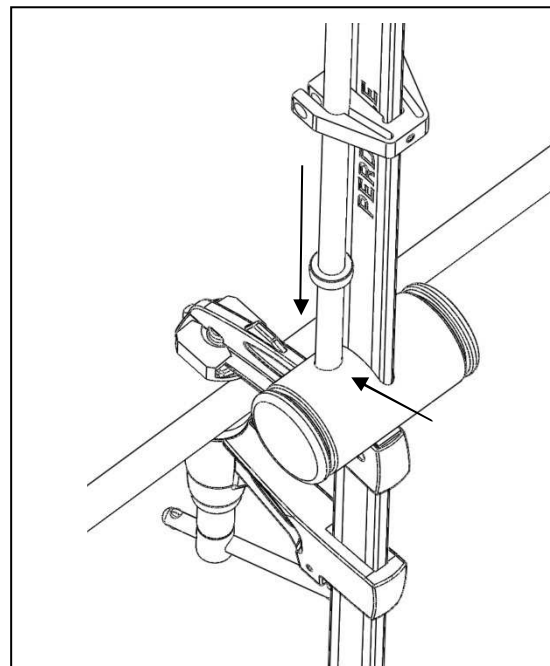

12 ... slide the bow into the bottom of the drum hole. Be careful, the bow can rotate because it is not yet blocked by the handle.

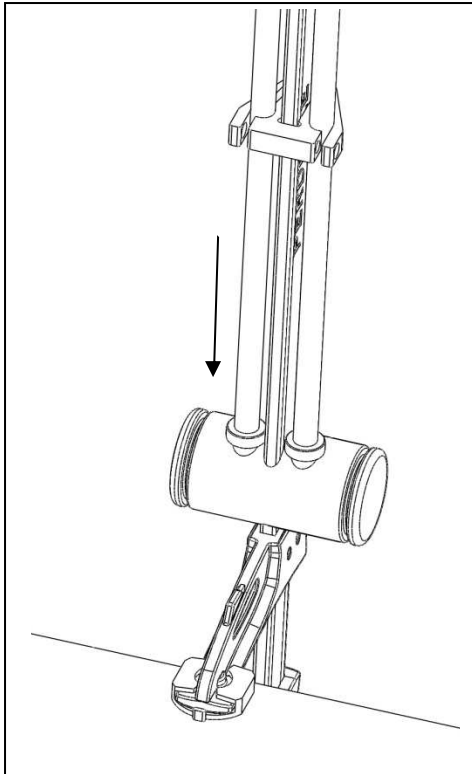

13 Repeat the operation with the 2nd bow.

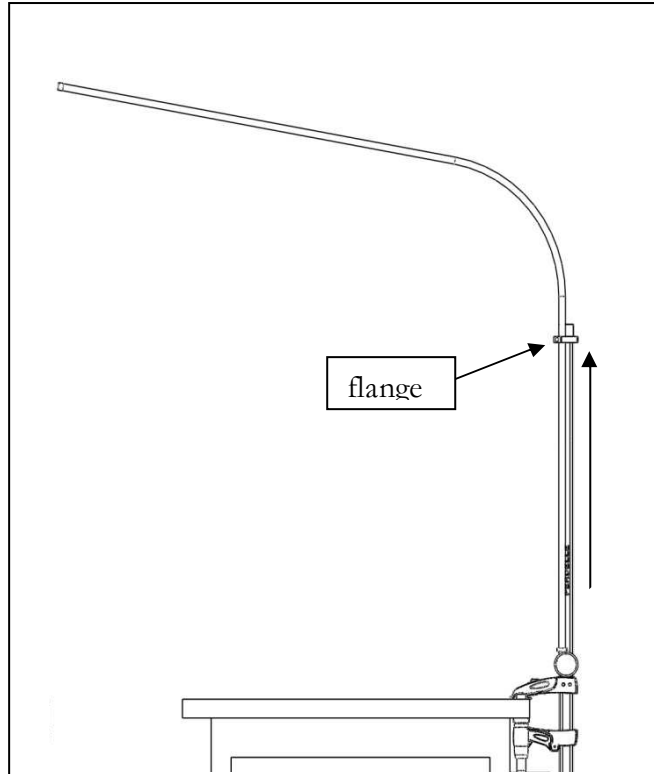

14 While holding the 2 bows with one hand, mount the flange with the other hand about 2mm from the cap. Make sure the bows do not come out of the drum during this operation.

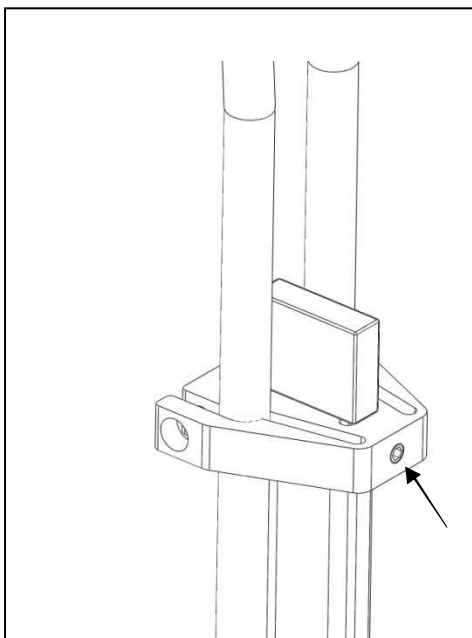

15 Tighten the screw to 3 N.m

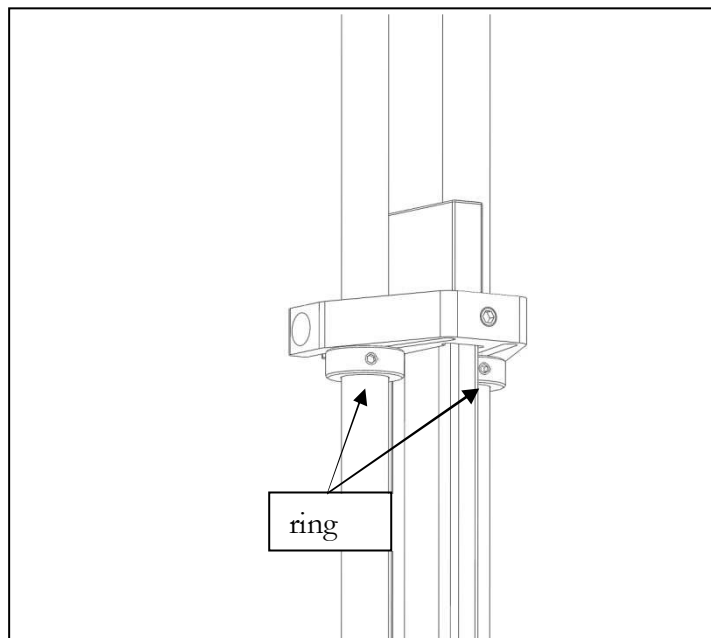

16 Slide the two rings until they touch the flange and tighten the screws to 0.5 N.m. /CAUTION Check to make sure that the bows have been pushed to the bottom of the holes of the drum.

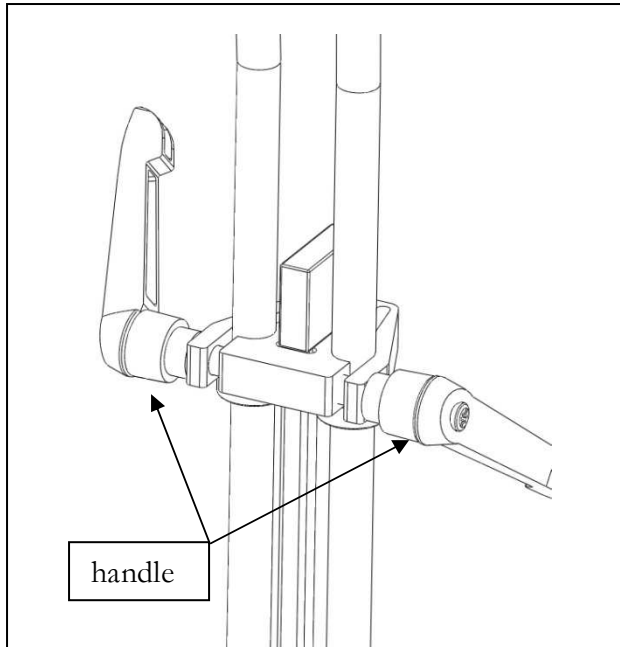

17 Screw in the two levers while pointing the bows towards the workstation and then, with just the right amount of force, lock the bows. There is no need to force the levers, they are easily locked. The levers are indexable.

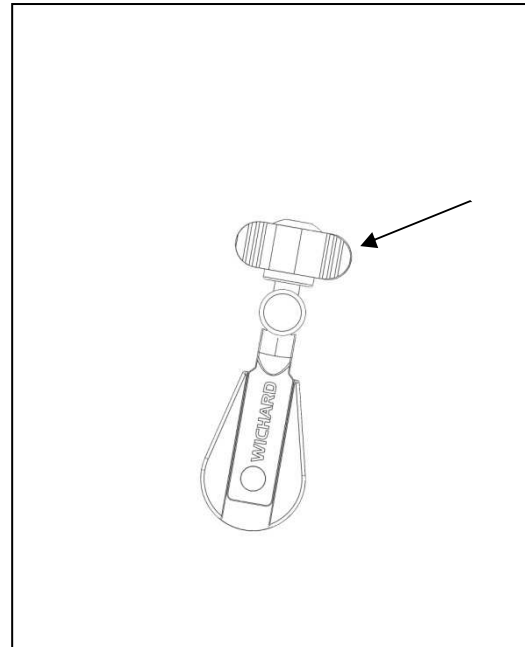

18 Put the 4 thumb screws onto the 4 pulleys.

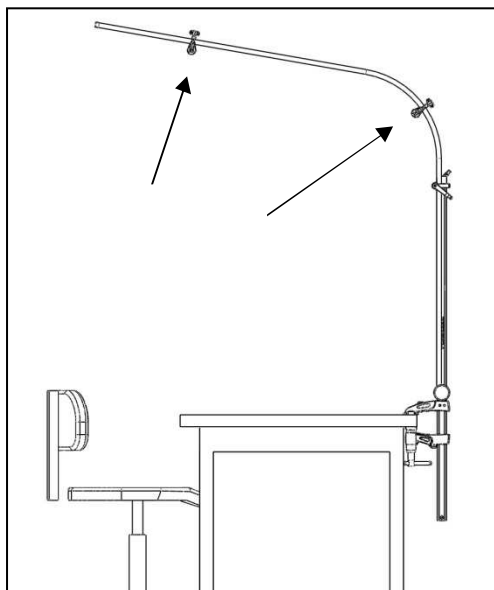

19 Slide the 4 pulleys approximately as shown in the figure and tighten the thumb screws slightly. Do not use a tool to tighten the thumb screws. We will see the adjustment below.

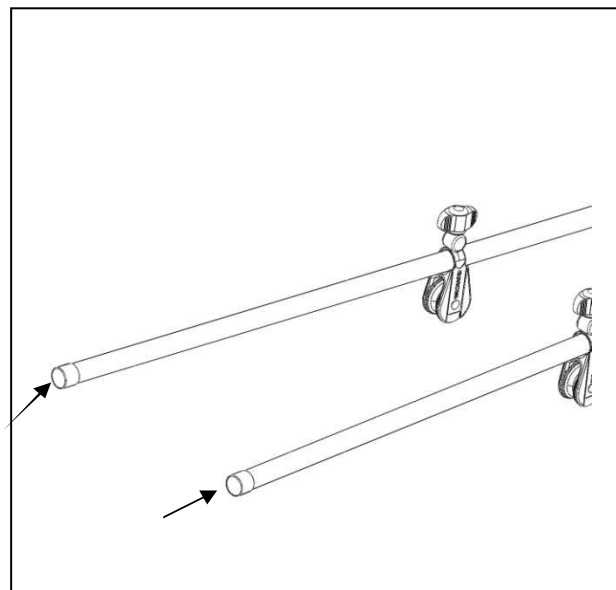

20 Insert the two plugs into the ends of the bows.

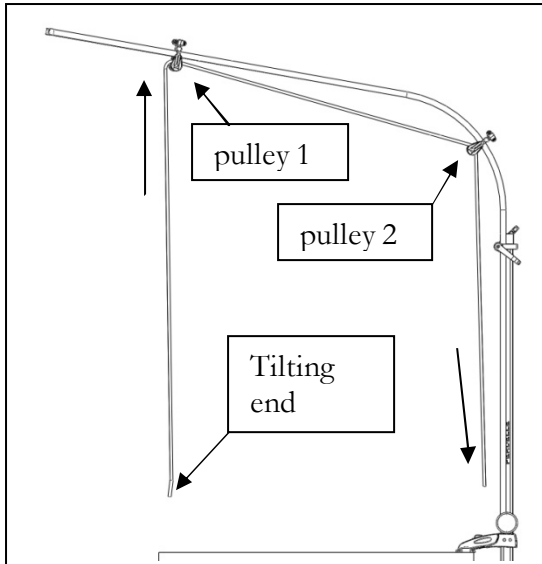

21 Thread the elastics through the pulleys, tilting end on the operator's

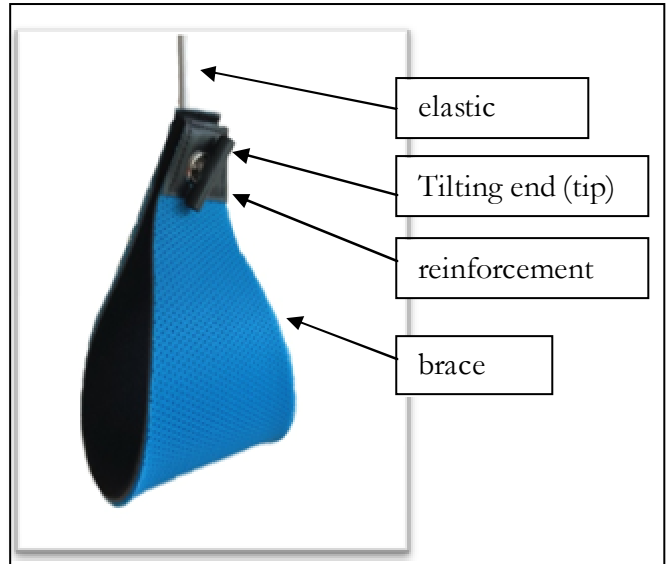

22 Tilt the tips after passing them through the grommets of the brace.



23 Pull on the elastic to bring the bottom of the brace to about 50 cm from the work surface.

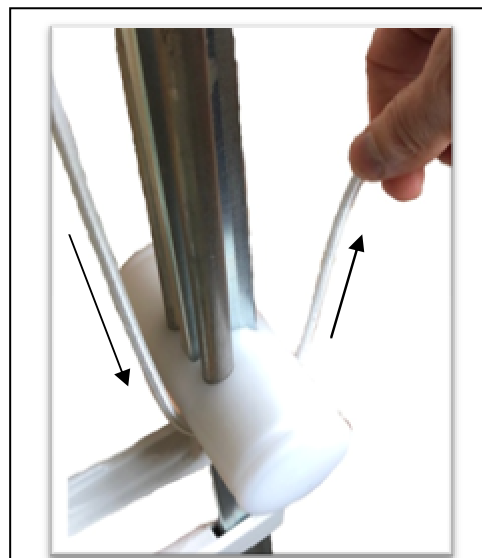

24 Pass in front of the drum, on the operator's side, then go up behind.



25 Then pass between the bow and the bar of the clamp then

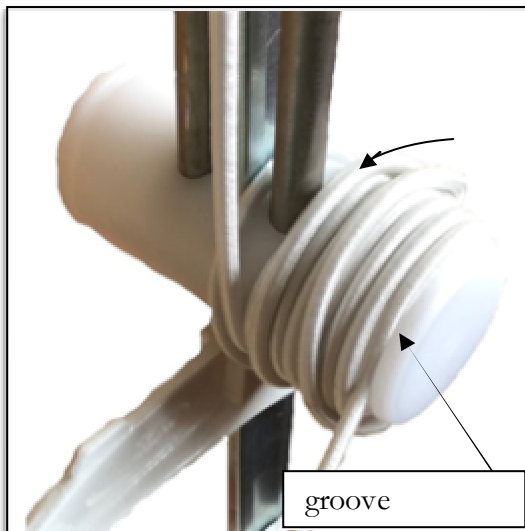

26 ... wind the rubber band at least 4 turns and insert its end in the groove provided for this purpose. The rest of the rubber band can hang down.



27 Repeat the process for the second elastic. Perdelle-Néo is ready to be adjusted.

6. THROUGH-HOLE MOUNTING

This configuration can be used in the case of a deep bench (Picture B page 2).

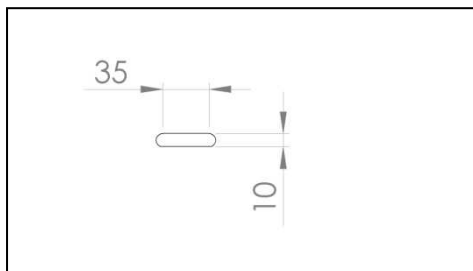

28 Make a 10 mm by 35 mm hole in the thickness of the workbench.

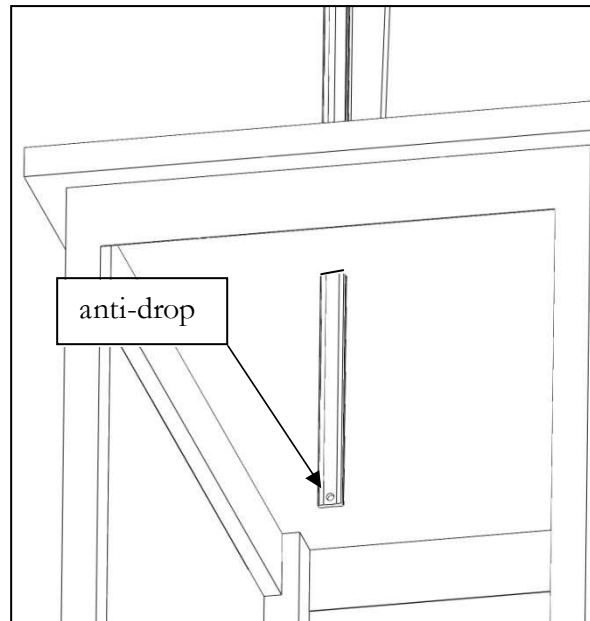

29 Unclip the drop prevention device from the clamp.
Remove the lower jaw.
Pass the clamp through the hole.

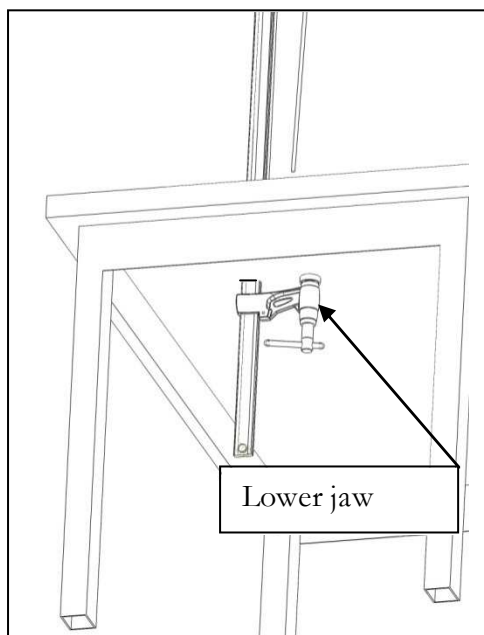

30 Reassemble the lower jaw and tighten it between 1.5 and 2 turns, then clip on the drop prevention device.

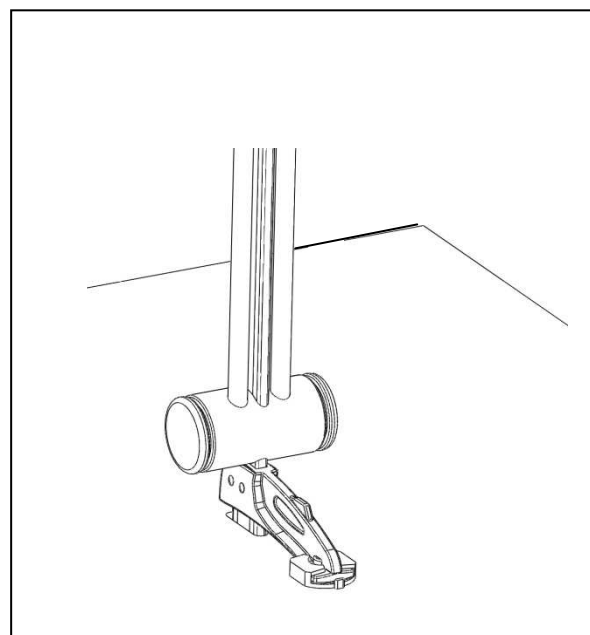

31 Continue the assembly as indicated above in "Classic assembly".

7. ADJUSTMENT

Adjusting the pulley position:

Position the pulleys over the area where the operator's forearms are most often activated. Use the rotation of the bows and the sliding of the pulley to do this.

Adjusting the holding force:

We recommend a force of about 1.5 kg, which allows the arms to always work a minimum. For this adjustment, place a 1.5 liter bottle of water in a brace and play with the drum adjustment to bring the bottom of the brace to the level of the work surface. Repeat this operation for the second arm.

Perdelle-Néo is ready to be used.

8. OPERATION

The user will quickly get used to the comfort offered by Perdelle-Néo. Within a few hours, the user will find the best adjustment that suits him/her.

The brace can be placed at about 10 cm from the wrist to start with. Depending on the comfort of each person and the operations to be performed, the position of the armbands can vary.

Some jobs require occasional wide movements on one side or the other of the workstation. Perdelle-Néo offers the possibility of leaving one or both arches free to rotate.

If several operators use Perdelle-Néo, it is possible to order one brace per user.

If several people use the same Perdelle-Néo, it is possible to keep the previous setting by marking the elastic band on the drum with a colored marker.

9. CLEANING

Perdelle-Neo does not require any particular upkeep. It can be cleaned with a soft cloth if necessary. Do not use any chemical products.